

SD card, Card stay detection switch Top mount, Push-lock push-eject connector

P/N : FPS009-2920-0

Feature

- Push-lock push-eject type
- Low profile design H=2.80mm
- Top mount
- Card stay detection switch integrated
- Card detection switch integrated
- SDIO capable
- Card fly-out minimize design
- EMI prevention design
- RoHS compliant
- Pb-free soldering capable

Specification

Current Rating	0.5 A
Voltage Rating	5.0V rms
Insulation Resistance	At 500V DC Initial value : 1000M Ω After test : 100M Ω max.
Withstanding Voltage	500V AC rms, 1 min.
Contact Resistance	At 1mA/20mV Initial value : 100m Ω After test : 40m Ω max.
Operating Temperature	-25 $^{\circ}$ C ~ +85 $^{\circ}$ C
Durability	10,000cycles

Outline Dimension

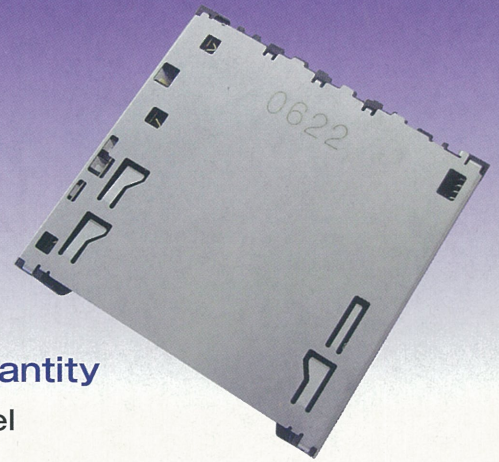
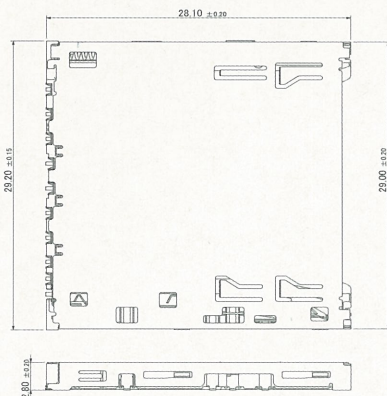

Packing Quantity

500pcs/reel

Material & Plating

Insulator	Heat Resistance Plastic
Ejector	SUS
Metal Shell Cover	SUS
Soldering Tub	Copper Alloy, Ni-Sn
Contact	Copper Alloy, Ni-Au/Sn
Card Stay Detection Switch	Copper Alloy, Ni-Au/Sn
Card Detection Switch	Copper Alloy, Ni-Au/Sn
Common Contact	Copper Alloy, Ni-Au
Write Protect Switch	Copper Alloy, Ni-Au/Sn
Coil Spring	SUS

Recommended Foot Pattern

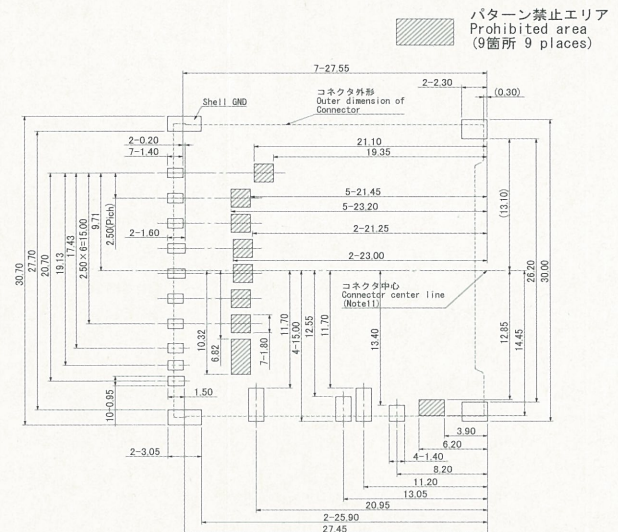

* Please request latest drawing and specification when this P/N is considered to adopt.

Issued: 2010 Sept. Rev. A



YAMAICHI ELECTRONICS Co.,Ltd.

3-28-7 Nakamagome, Ota-ku, Tokyo 143-8515, JAPAN

TEL: +81-3-3778-6160 FAX: +81-3-3778-6177

URL: <http://www.yamaichi.com>

Specification in this document is as for reference on representative p/n of each series and may change without prior notice. Since product improvement entails changes to electrical, material and mechanical properties, the purchasing party is strongly recommended to inquire the latest specification before placing purchase order. All other service, product and company names mentioned herein are the trademark or registered trademarks of their respective owners.

Yamaichi Electronics U.S.A. Inc.

475 Holger Way, San Jose, CA 95134, U.S.A.

TEL: +1-408-715-9100 FAX: +1-408-715-9199 <http://www.yamaichi.us>

Yamaichi Electronics Deutschland GmbH

Karl-Schmid-Strasse 9, D-81829 Munich, GERMANY

TEL: +49-89-45109-0 FAX: +49-89-45109-110 <http://www.yamaichi.de>

Yamaichi Electronics Hong Kong Ltd.

Unit 815-16 8F Tower 1 Grand Central Plaza, 138 Shatin Rural Committee Road, Shatin, N.T., HONG KONG

TEL: +852-2687-1968 FAX: +852-2601-9681 <http://www.yamaichi.com.cn/hk>

Asia Yamaichi Electronics Inc.

505, Kyungin B/D, 166-3, SamSeong-Dong, Gangnam-Gu, Seoul, 135-881, KOREA

TEL: +82-2-557-0522 FAX: +82-2-557-0622 <http://yamaichi.co.kr>

Yamaichi Electronics Singapore Pte. Ltd.

72 Bendemeer Road #04-21, Luzerne, Singapore 339941

TEL: +65-6297-8312 FAX: +65-6297-8141 <http://www.yamaichi.com.sg>

Yamaichi Electronics Taiwan Co., Ltd.

9F-1021, No. 144, Sec. 3, Min Chuan E. Road, Taipei, TAIWAN, R.O.C.

TEL: +886-2-2546-0507 FAX: +886-2-2546-0509 <http://www.yamaichi.com.tw>