

# Plastic Mold Visible LEDs KED663M51

## Features

- Transparent epoxy mold
- High power:4mW
- Direct modulation

## Applications

- Optical switches
- Optical instruments
- Automatic control apparatus

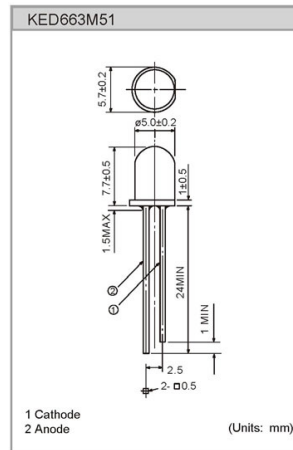

## Specifications

### Absolute Maximum Ratings

Parameter	Symbol	Value	Unit	Conditions
Forward current	$I_F$	50	mA	
Peak forward current	$I_{FP}$	0.5	A	Puls width=100 $\mu$ s, Duty ratio=1%
Reverse voltage	$V_R$	6	V	
Power dissipation	$P_D$	120	mW	
Operating temperature	$T_{opr}$	-20 to +80		Avoid dew condensation
Storage temperature	$T_{stg}$	-30 to +100		Avoid dew condensation
Soldering temperature	$T_{sol}$	260		Soldering time less than 5 seconds

### Electrical and Optical characteristics

Parameter	Symbol	Value			Unit	Conditions
		Min.	Typ.	Max		
Forward voltage	$V_F$		1.8	2.3	V	$I_F=20mA$
Reverse Current	$I_R$			10	$\mu A$	$V_R=6V$
Luminous Intensity lv	LV		400		mcd	$I_F=20mA$
Optical output power	$P_O$		4		mW	$I_F=20mA$
Peak wavelength	$\rho$		660		nm	$I_F=20mA$
Spectral width			25		nm	$I_F=20mA$
Half angle	2		40		deg	$I_F=20mA$

