

THIS DRAWING IS UNPUBLISHED. RELEASED FOR PUBLICATION
 © COPYRIGHT BY TYCO ELECTRONICS CORPORATION. ALL RIGHTS RESERVED.

LOC	DIST	REVISIONS					
J	—	P	LTR	DESCRIPTION	DATE	DWN	APVD
			H	REVISED ECR-07-011428	13JUN'07	J.S	S.M
			H2	REV PER ECR-13-000284	1AUG13	B.P	YHM

ロケーション・マーク
LOCATION MARK

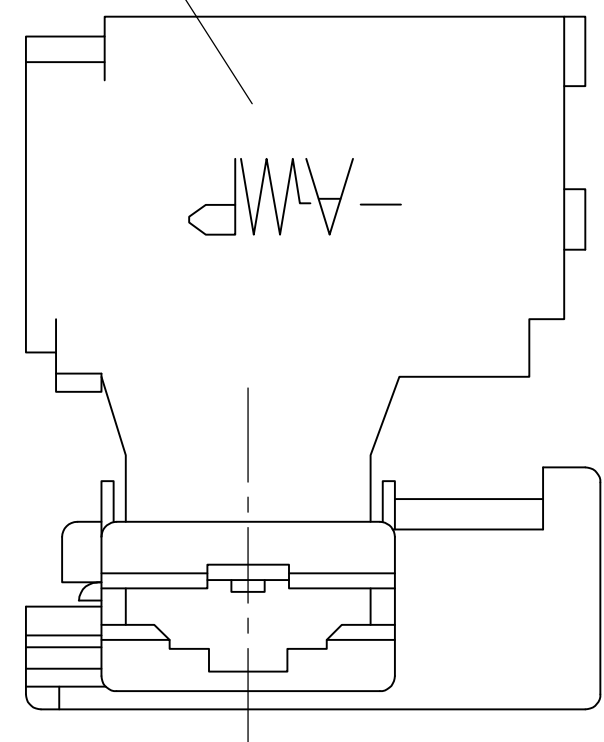
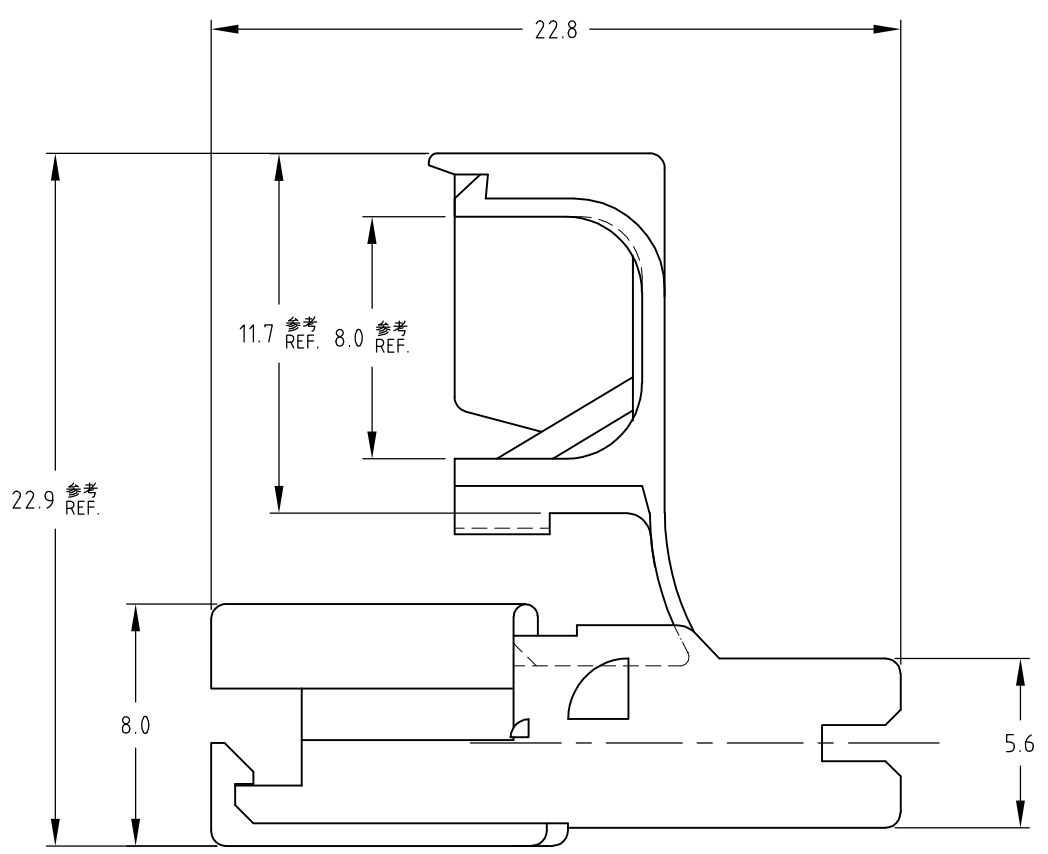
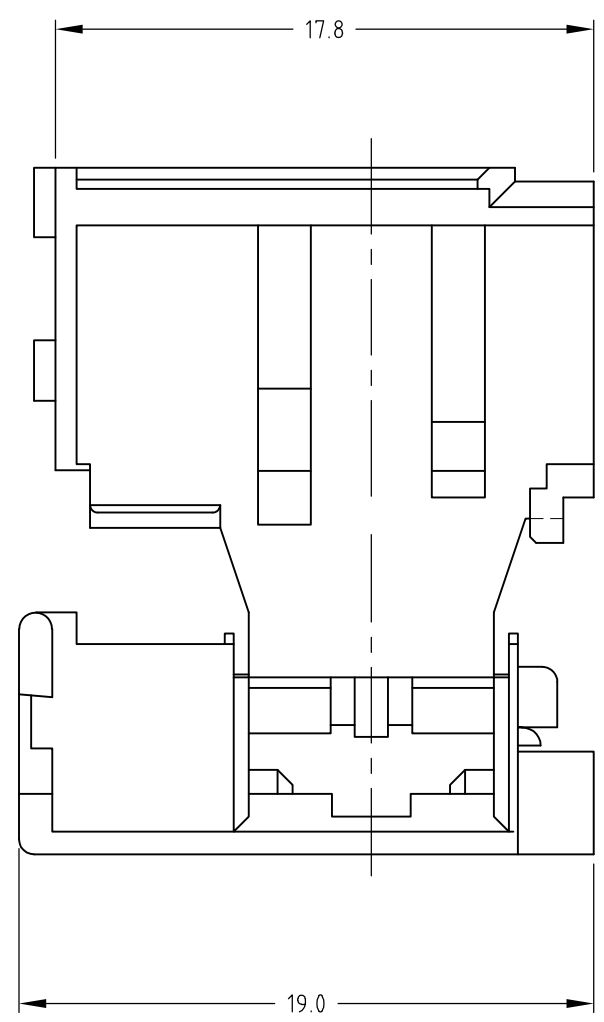

注；
 1. 適用コンタクト；
 型番：172761,172782,172763
 2. 取扱説明書；411-5212

NOTES ;
 1. APPLICABLE CONTACT
 PARTS NUMBER : 172761,172762,172763
 2. INSTRUCTION SHEET : 411-5212
 3. OBSOLETE PARTS: OBSOLETE CIS STREAMLINING
 PER D.RENAUD/D.SINISI
 4. COMPLY WITH GLOW WIRE REQUIREMENT FOR PARTS OF
 NON-METALLIC MATERIAL SUPPORTING A CURRENT CARRYING
 CONNECTION DETAILED IN IEC 60335-1, SECTION 30 (GWT)

	7-172469-1 ⁴	自然色 NATURAL	6/6ナイロン 6/6 NYLON	UL94V-0, GWT
³ OBSOLETE	1-172469-3	黄 YELLOW		UL94V-0
	1-172469-2	青 BLUE		UL94V-0
	1-172469-1	自然色 NATURAL		UL94V-0
	172469-8	黒 BLACK		UL94V-2
³ OBSOLETE	172469-7	赤 RED		UL94V-2
	172469-4	緑 GREEN		UL94V-2
	172469-3	黄 YELLOW		UL94V-2
	172469-2	青 BLUE		UL94V-2
	172469-1	自然色 NATURAL		UL94V-2
	型番 PART NUMBER	色調 COLOR	材料 MATERIAL	

THIS DRAWING IS A CONTROLLED DOCUMENT.		DWN M.SUZUKI 17.APR.'02	Tyco Electronics Tyco Electronics AMP K.K. Kawasaki, Japan	
DIMENSIONS: 単位： 耗 mm		CHK M.SHINDO 17.APR.'02	NAME 名称 250 SERIES FLAG POSITIVE LOCK MARK-II HOUSING	
TOLERANCES UNLESS OTHERWISE SPECIFIED: 一般公差		APVD M.SHINDO 17.APR.'02	PRODUCT SPEC 製品規格 108-5162	
0 PLC ±0.4		APPLICATION SPEC 取付適用規格		
1 PLC ±		SIZE A3		
2 PLC ±		CAGE CODE 00779		
3 PLC ±		DRAWING NO G-172469		
4 PLC ±		RESTRICTED TO		
ANGLES ±3'		SCALE 尺度 4:1		
MATERIAL 材料 SEE TABLE		SHEET 1 OF 1		
		REV H2		