

THIS DRAWING IS UNPUBLISHED. RELEASED FOR PUBLICATION
 © COPYRIGHT - By - ALL RIGHTS RESERVED.

REVISIONS				
P	LTR	DESCRIPTION	DATE	APVD
S8		REVISED PER ECO-16-015057	20OCT2016	RS KR

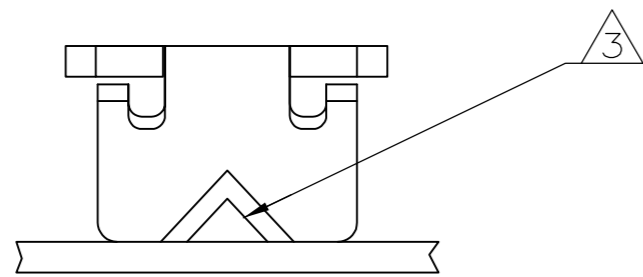

- 1 CONTINUOUS STRIP ON REELS WITH TERMINALS LOCATED ON 5.59±0.08 [.220±.003] CENTERS.
- 2 SLOT ACCEPTS 0.80-1.20mm [#20-#16.5] AWG COPPER MAGNET WIRE.
SLOT ACCEPTS 0.95-1.15mm [#18.5-#17] AWG ALUMINUM MAGNET WIRE.
ALUMINUM WIRE RANGE APPLIES FOR POST-TIN PLATED VERSIONS ONLY. A SINGLE WIRE ONLY.
- 3 POKE-IN ACCEPTS A 0.50-0.90mm² [#20-#18] AWG SOLID OR FUSED STRANDED LEAD WIRE.
- 4 TIN PLATED
- 5 PAPER SPLICED - RESTRICTED TO BSH GERMANY
- 6 SPLICE FREE
- 7 PRELIMINARY PRODUCTION

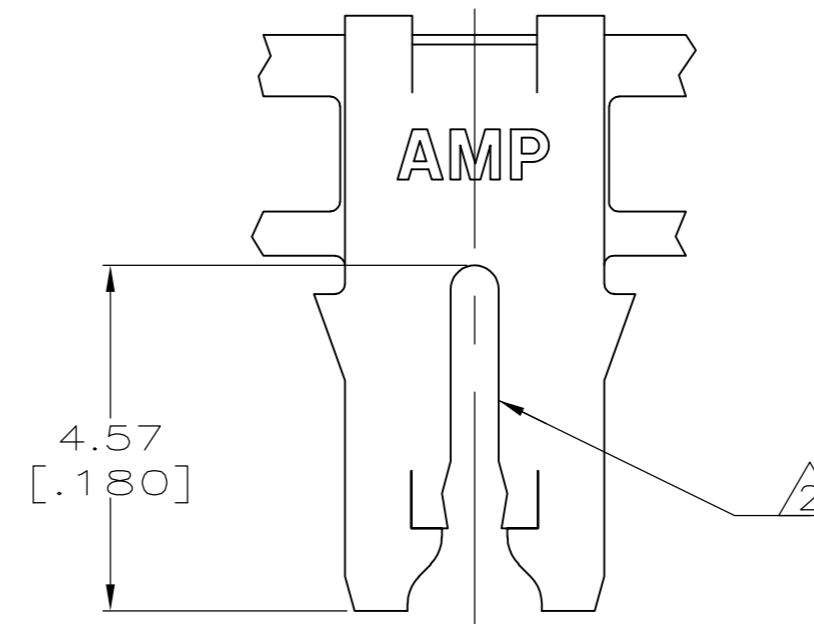
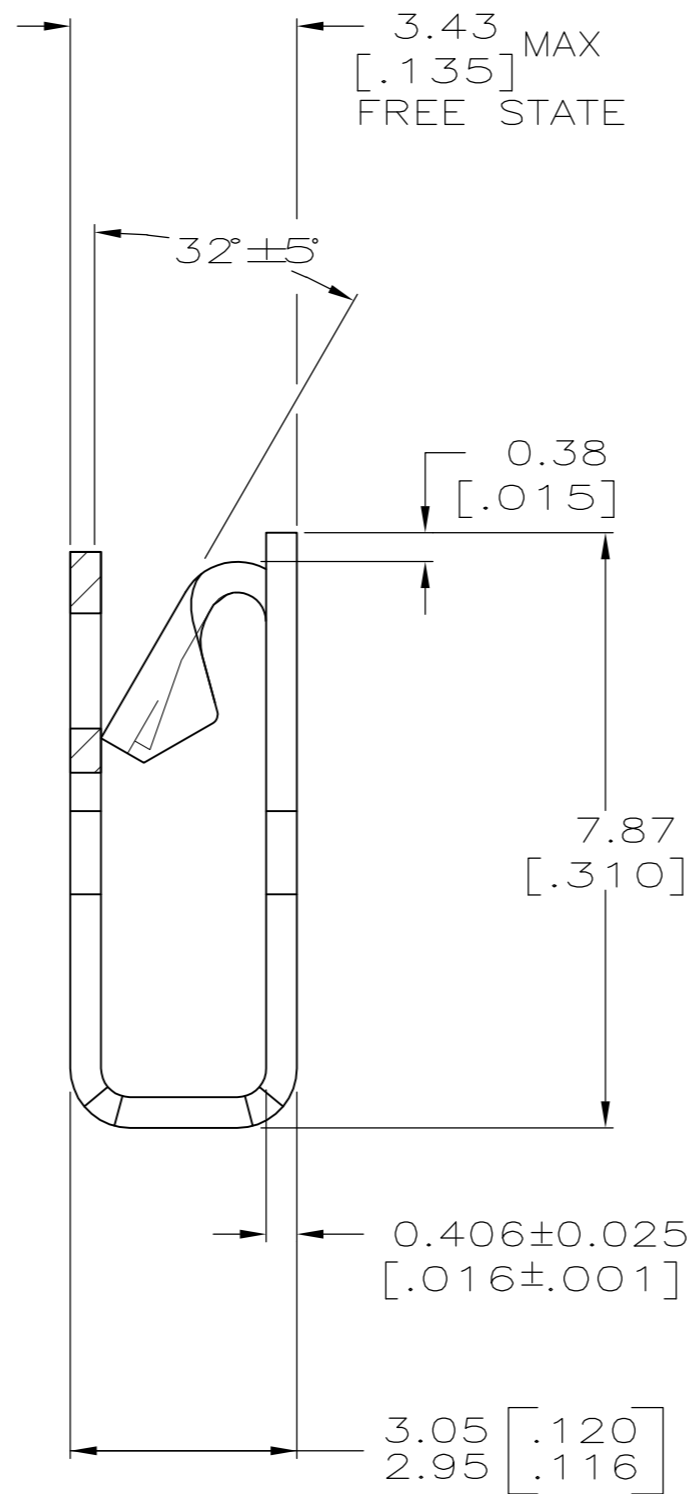
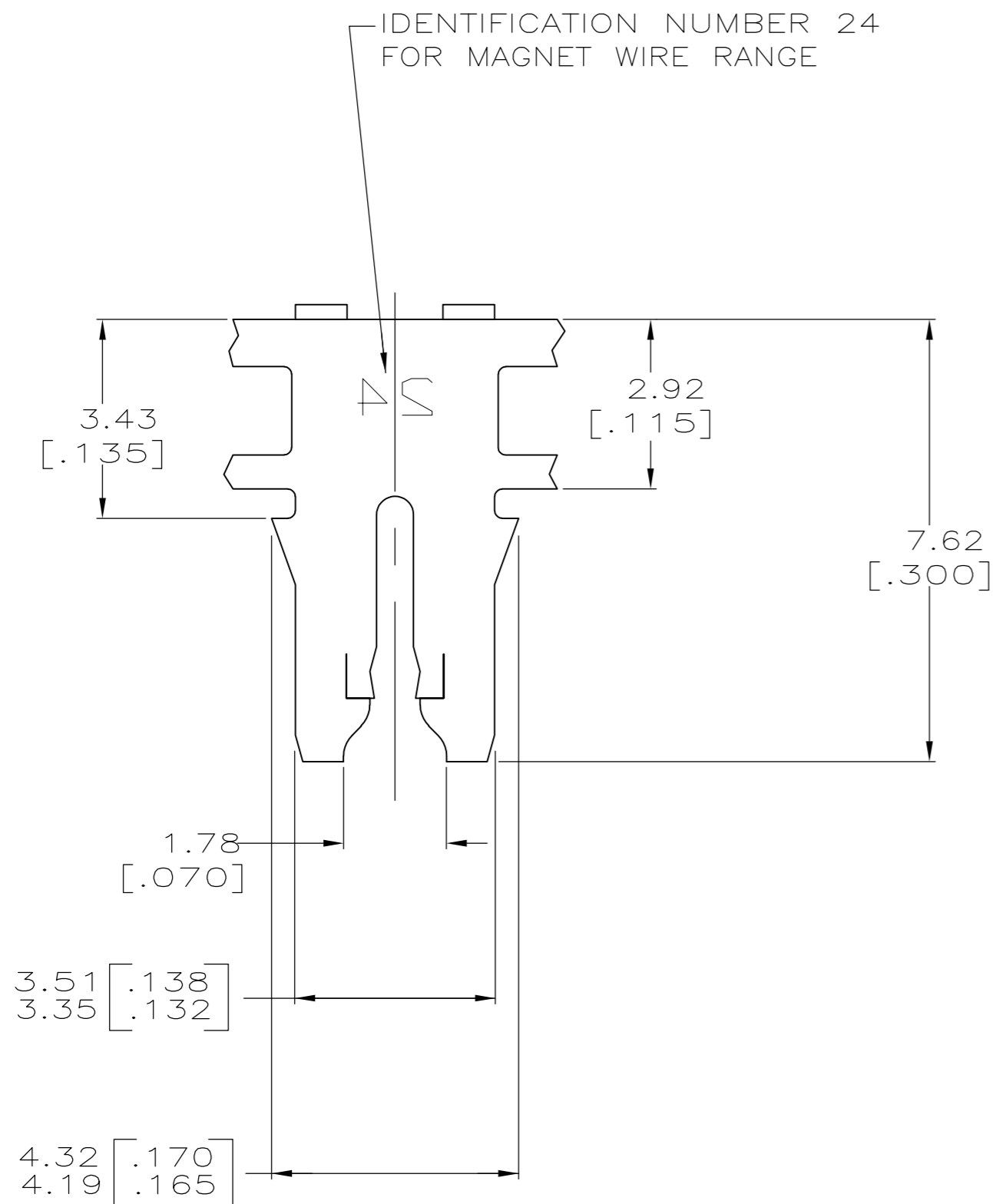

CU-NI-SI	STANDARD	7 62833-9
BRASS	STANDARD	6 62833-8
BRASS	STANDARD	5 62833-6
PHOSPHOR BRONZE	STANDARD	62833-4
PHOSPHOR BRONZE	REVERSED	62833-3
BRASS	REVERSED	62833-2
BRASS	STANDARD	62833-1
MATERIAL	REELING	PART NO.

OBSOLETE

THIS DRAWING IS A CONTROLLED DOCUMENT.		DWN R.R. BUCHHEISTER JR. 1/SEP/94	TE TE Connectivity	
DIMENSIONS: INCHES		CHK MS FEHER 02SEP94		
TOLERANCES UNLESS OTHERWISE SPECIFIED:		APVD MS FEHER 02SEP94	NAME TERMINAL, POKE-IN, 300 SERIES MAG-MATE	
0 PLC ± -		PRODUCT SPEC 108-2012	SIZE A2	
1 PLC ± -		APPLICATION SPEC 114-2046	CAGE CODE 00779	DRAWING NO 62833
2 PLC ± 0.25 [.010]		WEIGHT 0	SCALE 10:1	SHEET 1 of 1
3 PLC ± -		FINISH - 4	RESTRICTED TO -	REV S8
4 PLC ± -		MATERIAL SEE TABLE	CUSTOMER DRAWING	