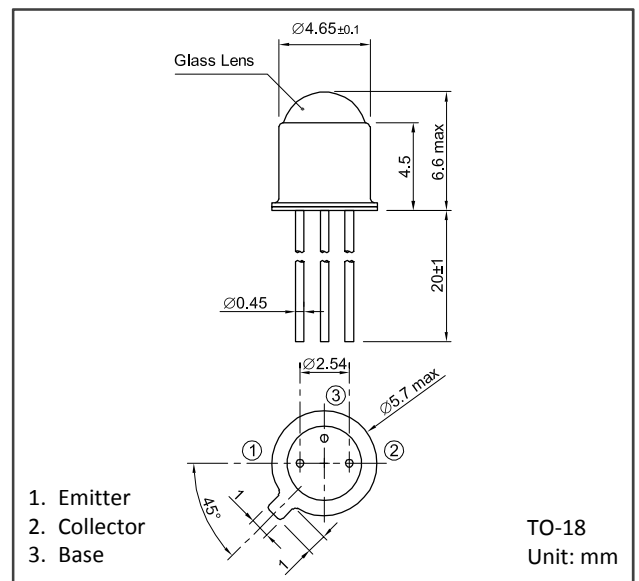

Features

- NPN phototransistor packaged in a 3 leads TO-18 for base connection
- Hermetic seal with a glass lens
- Low leak current

Applications

- Optical switches
- Optical encoders
- Photo-isolators
- Camera stroboscopes
- Infrared sensors
- Automatic control apparatus

**Absolute Maximum Ratings**

Parameter	Symbol	Value	Unit	Note
Collector-emitter voltage	V_{ce0}	20	V	
Emitter-collector voltage	V_{eco}	5	V	
Collector-base voltage	V_{cbo}	30	V	
Emitter-base voltage	V_{ebo}	5	V	
Collector dissipation	P_D	125	mW	
Operating temperature	T_{opr}	-25 to +125	°C	Avoid dew condensation
Storage temperature	T_{stg}	-55 to +150	°C	Avoid dew condensation

Electrical and Optical Characteristics (Ta=25°C unless otherwise noted)

Parameter	Symbol	Min.	Typ.	Max.	Unit	Test Condition
Active area	S	0.64 x 0.64			mm ²	
Sensitive wavelength	λ	400	800(λ_p)	1000	nm	λ_p =Peak wavelength
Photocurrent	I_L	-	2	-	mA	$V_{ce}=5V$, 100lx (@2856K)
Dark current	I_{ceo}	-	100	200	nA	$V_{ce}=20V$
Current amplification factor	h_{FE}	600	-	-	-	$V_{ce}=5V$, $I_C=2mA$
Collector-emitter saturation voltage	$V_{ce(sat)}$	-	-	0.4	V	$I_C=0.1mA$ 100lx (@2856K)
Rise / fall time	t_r, t_f	-	5	-	μs	$V_{ce}=5V$, $I_C=2mA$, $R_L=100\Omega$

Collector Dissipation - Ambient Temperature

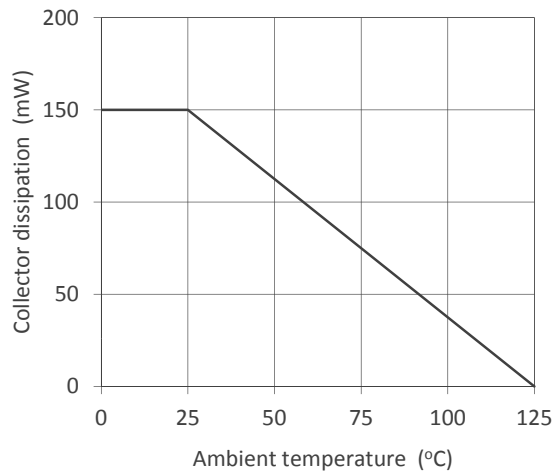

Photocurrent - Collector-Emitter Voltage

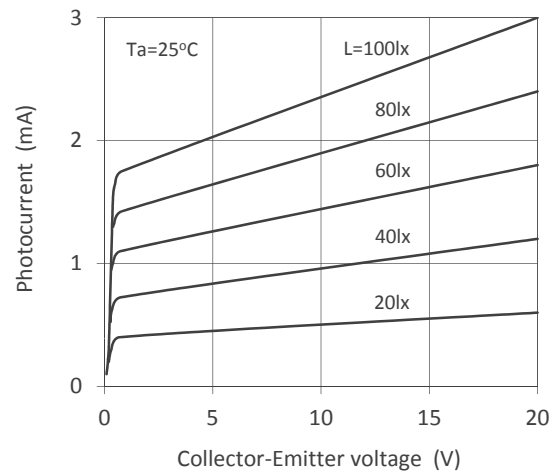

Photocurrent - Illuminance

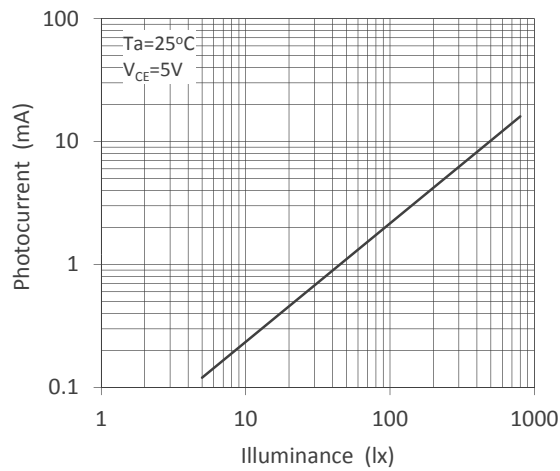

Dark Current - Ambient Temperature

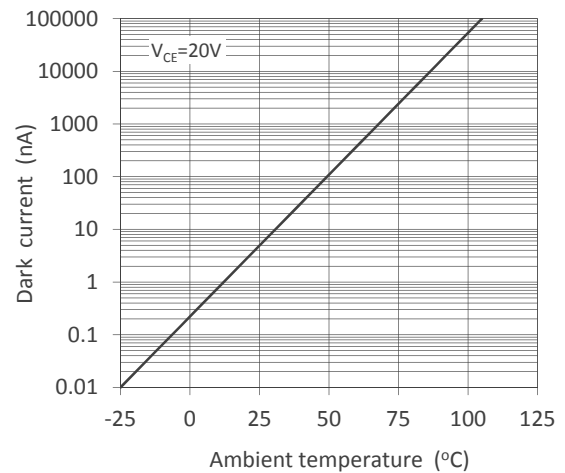

Spectral Responsivity

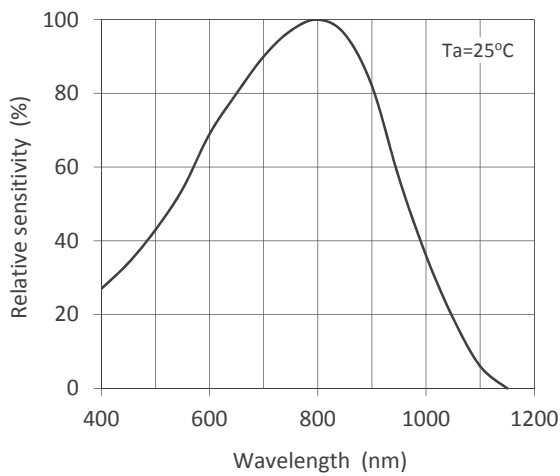

Directivity

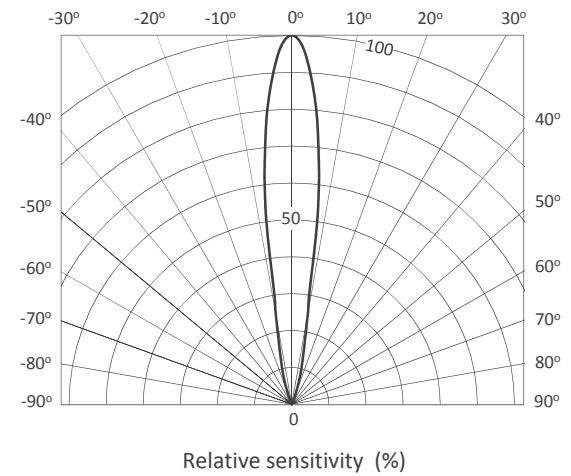

- Specifications, characteristics, data, materials, structures specified in this datasheet are subject to change without notice. Please refer to the latest specification before use of the products.
- Products listed in this datasheet comply with the RoHS Directive (EU2002/95/EC).

Opto-technologies for the Future



KYOSEMI CORPORATION

<http://www.kyosemi.co.jp/>

Headquarters : 949-2 Ebisucho Fushimi-ku, Kyoto 612-8201 Japan

TEL: +81-75-605-7311

Tokyo Sales Office: 24th Sky Bldg.2F, 1-34-3 Shinjuku Shinjuku-ku, Tokyo 160-0022 Japan

TEL: +81-3-5312-5360

Kansai Sales Office: 949-2 Ebisucho Fushimi-ku, Kyoto 612-8201 Japan

TEL: +81-75-605-7311

Kyosemi Opto America Corp: 4655 Old Ironsides Suite 230 Santa Clara, California 95054 USA

TEL: +1-408-492-9361

Eniwa Operation: 358-31 Toiso Eniwa-shi, Hokkaido 061-1405 Japan

TEL: +81-123-34-3111

Kamisunagawa Operation: 70-1 Kamisunagawa Kamisunagawa-cho Sorachi-gun, Hokkaido 073-0200 Japan

TEL: +81-125-62-3611