

NUMBER
C153226

3rd ANGLE (AMERICAN) PROJECTION

DIMENSIONS IN INCHES. DO NOT SCALE PRINT
DIMENSIONS THUS [] IN MM.

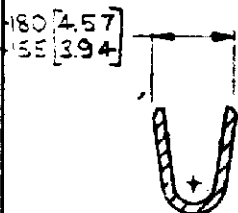
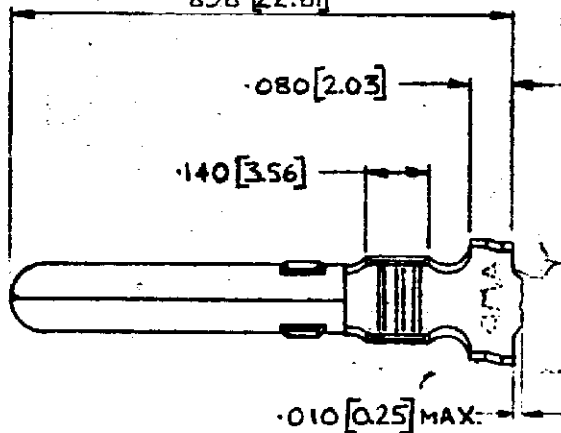
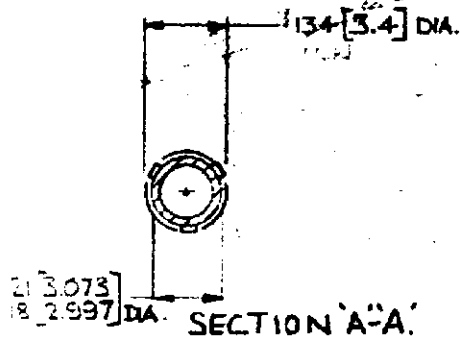

SECTION B-B

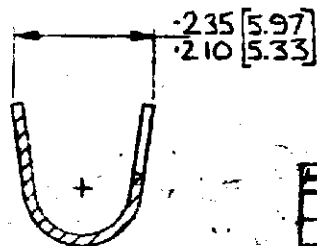

SECTION C-C

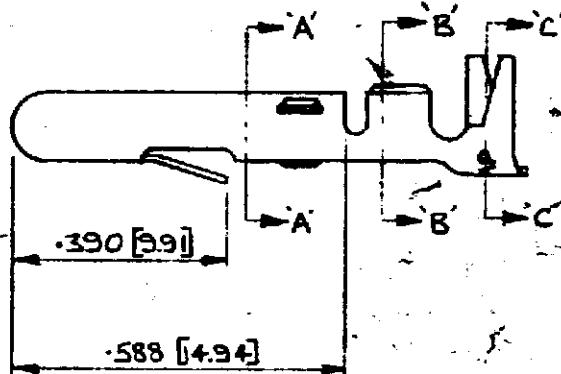

INSULATION 170-170 [B.05-4.32]

PART NO.	FINISH	MATERIAL
153226-1	PRE-TIN	BRASS (REVERSE SIDE)
153226-5	PRE-TIN	PHOS BRONZE
153226-4	ELECTRO-TIN	BRASS
153226-3	NONE	PHOS BRONZE
153226-2	NONE	BRASS
153226-1	PRE-TIN	BRASS

M	DESIGNED	AEH	50	1971
L	DR	PS	50	1971
K	WIRE GAUGE SPECIFICATIONS ADDED	P		
J	.134 DIA. MAIN ALLED	DAV		
H	170-170 ADDED TO LIST	CS		
G	REDRAWN MACHINE	PS		
F	REVISION RECORD	OP	CRK	DATE
DR	PS SMITH			

AMP of GREAT BRITAIN LTD
1971.

CUSTOMER COPY
REFERENCE ONLY

MATERIAL AND FINISH	013 [2.33]	CLASS	
STOCK	SEE TABLE	TYPE	
WIRE GAUGE - INSULATION	20-35ML	SCALE	1:1
REFERENCE EXCEPT AS NOTED		REV	E A C-153226
115 [3] DIA LANCED PIN.			