

LOADCELL TYPE UMM1-50K to 2T

SPECIFICATIONS

● PERFORMANCE

| | |
|----------------------|---------------------------------|
| Rated capacity(R.C.) | : 490.3 N{50 kgf} |
| | : 980.7 N{100 kgf} |
| | : 1.961 kN{200 kgf} |
| | : 4.903 kN{500 kgf} |
| | : 9.807 kN{1 tf} |
| | : 19.61 kN{2 tf} |
| Safe overload | : 150 %R.C. |
| Ultimate overload | : 200 %R.C. |
| △ Rated output(R.O.) | : 2 mV/V±0.01 mV/V(COMPRESSION) |
| | -2 mV/V±0.01 mV/V(TENSION) |
| Non-linearity | : 0.15 %R.O. |
| Hysteresis | : 0.1 %R.O. |
| Repeatability | : 0.05 %R.O. |

● ELECTRICAL

| | |
|----------------------------|--------------------------|
| Recommended excitation | : 12 V or under |
| Maximum excitation | : 20 V |
| Zero balance | : ±0.06 mV/V |
| Input terminal resistance | : 425 Ω±50 Ω |
| Output terminal resistance | : 350 Ω±5 Ω |
| Insulation resistance | : 2000 MΩ or more(DC50V) |
| | (Bridge-Body) |

● TEMPERATURE

| | |
|-------------------------------|--------------------|
| Compensated temperature range | : -10 ℃ to 70 ℃ |
| Safe temperature range | : -20 ℃ to 80 ℃ |
| Temperature effect | : ±0.05 %R.O./10 ℃ |
| on zero balance | |
| Temperature effect | : ±0.1 %LOAD/10 ℃ |
| on output | |

● THE OTHERS

| | |
|----------------|----------------------------------|
| △ Cable | : φ6.3 4core shielded |
| | 3m connected Y-terminals |
| IP class | : IP67 |
| △ Weight | : Applox 0.6 kg |
| △ Material | : Stainless steel |
| △ Fatigue life | : 10 ⁶ under the R.C. |
| △ RoHS | : Compliant |

● Circuit

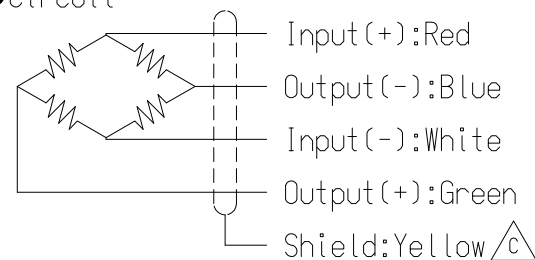

△ <<Accessories>>
Calibration certificate 1

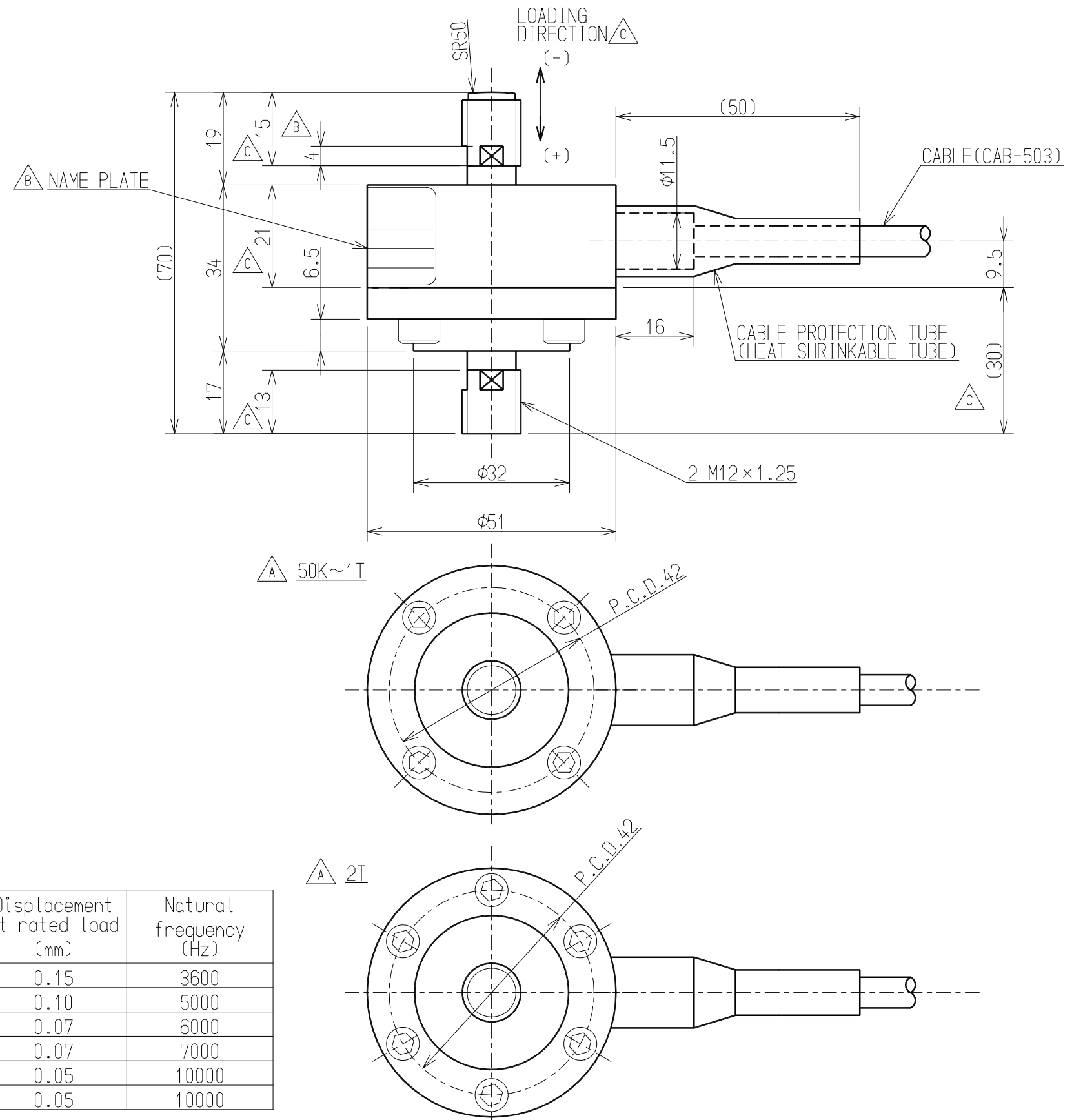

| TYPE | Displacement at rated load (mm) | Natural frequency (Hz) |
|-----------|---------------------------------|------------------------|
| UMM1-50K | 0.15 | 3600 |
| UMM1-100K | 0.10 | 5000 |
| UMM1-200K | 0.07 | 6000 |
| UMM1-500K | 0.07 | 7000 |
| UMM1-1T | 0.05 | 10000 |
| UMM1-2T | 0.05 | 10000 |

| | | | |
|---------|-----------|-------------|---------|
| D | 2016.3.30 | KN16-0150 | |
| C | 2012.7.24 | KN12-0285 | |
| B | 2010.2.26 | KN10-0057 | |
| A | 2010.1.12 | KN10-0007 | |
| - | 2003.1.14 | NEW | |
| 符号 MARK | 日付 DATE | 変更事項 REASON | ECN NO. |

| | | | | | |
|--|----|--|---|---|--------------------------|
| ミネベア株式会社 Minebea Co.,Ltd. センシングデバイス事業部 Sensing Device Business Unit | | 単位 UNIT mm 尺度 SCALE Free | 材質 MATERIAL 表面粗さ SURF.ROUGH. 熱処理 HEAT TREAT. 表面処理 FINISH | 作成日 DATE 2016.03.30 品名 DESCRIPTION OUTLINE 型式 MODEL NAME UMM1-50K to 2T 図番 DRAWING NO. KT51616-2 | 葉番 SHEET 改訂 REV. D |
| 公差 TOL | 一般 | DIMENSION L TOL <L≤4 ±0.1 4<L≤16 ±0.2 16<L≤63 ±0.3 63<L≤250 ±0.5 250<L≤1000 ±0.8 角度 DEG ±0.5 | | | |