

RT5318

2021/09/13

General Specifications

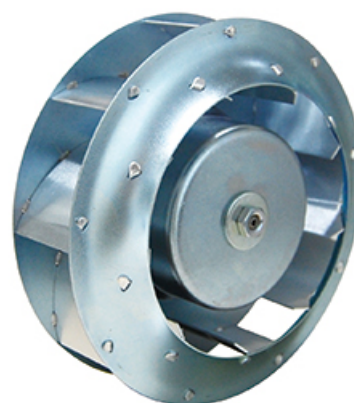

Motor Structure: 3-phase 2pole

Motor Protection: Thermal Protect

Insulation Resistance: 100MΩ or over with a DC500V Megger

Dielectric Withstand Voltage: AC1800V 1s

Allowable Ambient Temperature Range:

-20deg.C ~ +60deg.C

(Operating)

-40deg.C ~ +70deg.C

(Storage)

*no condensation permissible state practice.

Expected Life

*Failure rate 10% 25deg.C 25,000 hours (65%RH)

Outline



Material

Impeller: Steel

Bearing: Ball Bearings

Characteristic Curves

RT5318

2021/09/13

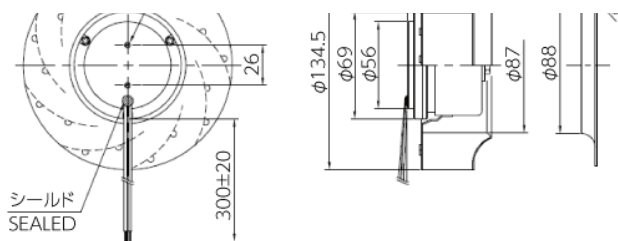

CHARACTERISTIC CURVES

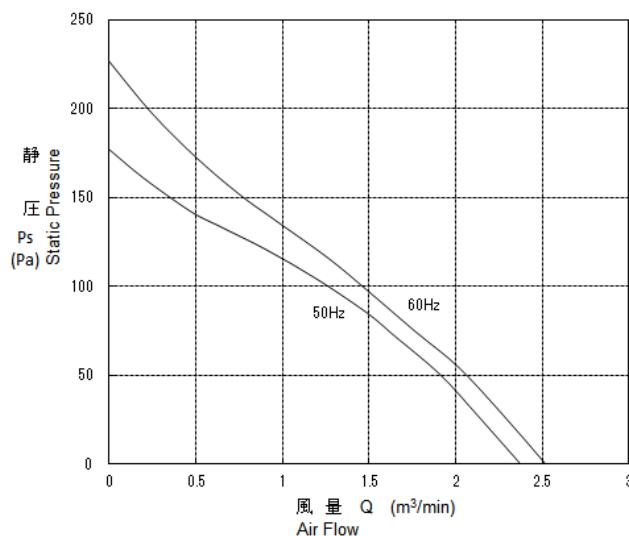

Specifications

Model	Product No	Phase	Nominal Voltage [V]	Operating Voltage lower limit [V]	Operating Voltage upper limit [V]	Frequency [Hz]
RT5318-0220W-B30F-S	00	3	200	180	220	50
RT5318-0220W-B30F-S	00	3	200	180	220	60

Model	Starting Voltage [V]	Current [A]	Input Power [W]	Speed [min ⁻¹]	Max. Air Flow [m3/min]	Fan Diameter [mm]	Fan Height [mm]
RT5318-0220W-B30F-S	130	0.069	20.7	2530	2.34	134.5	54.0
RT5318-0220W-B30F-S	130	0.074	26.4	2650	2.41	134.5	54.0

Model	Mass [g]
RT5318-0220W-B30F-S	670
RT5318-0220W-B30F-S	670

RT5318

2021/09/13
